



5555 N. River Road
Rosemont, IL

Admin. Office:
9301 W. Bryn Mawr
Rosemont, IL 60018
Phone: (847) 692-2220
Fax: (847) 696-9700
descenter@rosemont.com
www.rosemont.com

- Exhibit Space
- Meeting Space
- Lobby & Corridor
- Show Offices
- Skybridge
- Restaurant
- RES Service Centers
- Docks & Ramps

The Donald E. Stephens Convention Center offers extensive flexibility. Its six separate but connecting halls provide the capability of accommodating 3,566 10' x 10' exhibit booths, ranging from 100 to 1,225 booths in a single hall. The Rosemont Conference Center offers 92,000 square feet that will accommodate up to 50 meetings and a Ballroom for general sessions capable of hosting up to 4,000 people or banquets for 3,000.

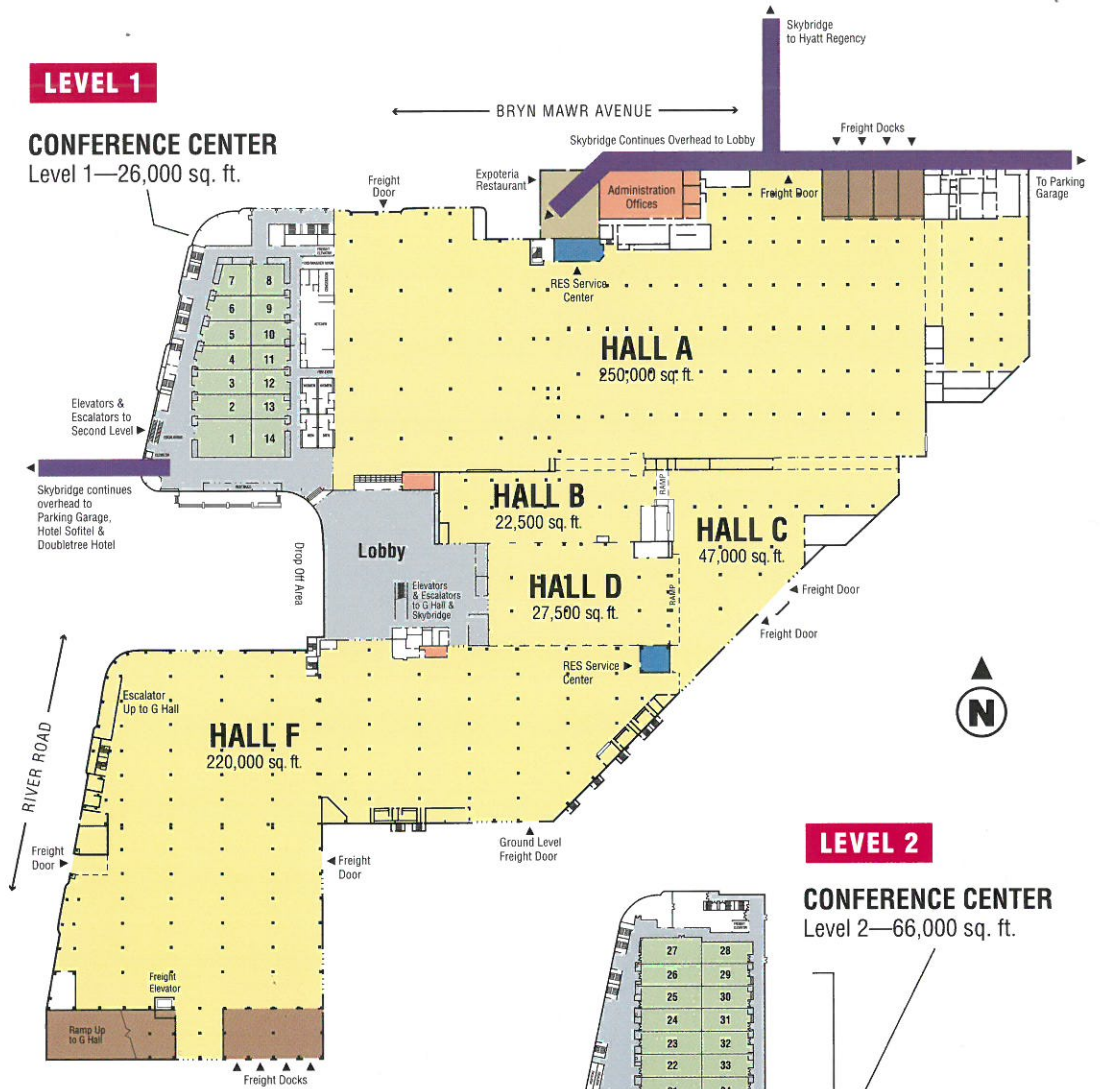

LEVEL 2

CONFERENCE CENTER
Level 2—66,000 sq. ft.

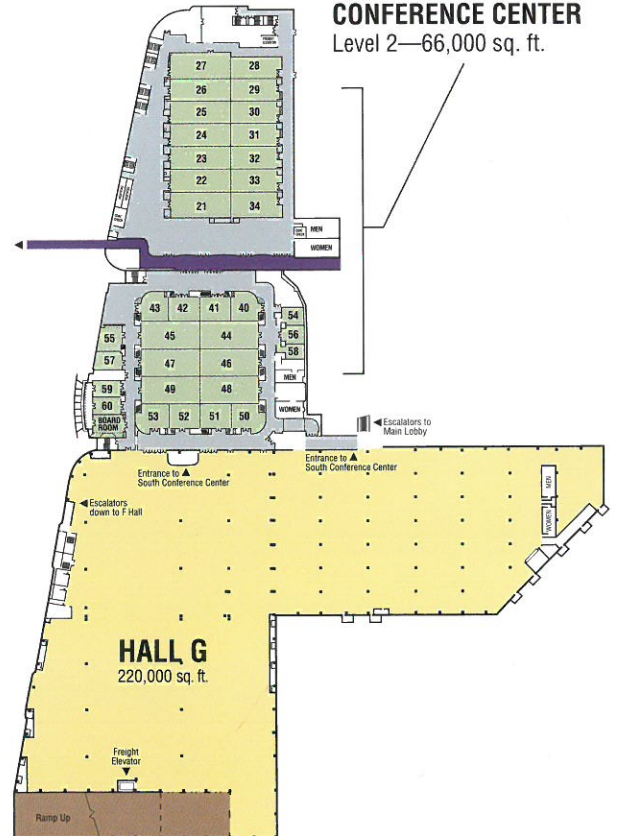

Exhibit Hall	Gross Sq.Ft.	Booth Capacity 10' x 10'	Ceiling Height	Floor Type
A	250,000	1225	19'6"	Concrete
B	22,500	115	18'6"	Concrete
C	47,000	191	18'6"	Concrete
D	27,500	125	24'6"	Concrete
F	220,000	955	18'6"	Concrete
G	220,000	955	18'6"	Concrete

Meeting Facilities	Gross Sq.Ft.	Capacity	Ceiling Height	Floor Type
Conference Center-Level 1	26,000	14 Rooms	17'	Carpet
Conference Center-Level 2	66,000	36 Rooms	17'	Carpet